



*Bulk CO<sub>2</sub> Systems*

# *Technical Service Bulletin*

## *Component Change*

*TSB-BEV-1006*

**Date:** March 3, 2016

**Subject:** New design Fill Box and updated vent line connections.

**Products Affected:** All new Chart Beverage System CO<sub>2</sub> fill boxes and existing fill boxes where new style vent lines are installed. This change adds a compression style fitting to attach the vent line to the fill box instead of a barb fitting. New style Chart vent lines require a compression fitting to be used instead of barb fittings.

**Description:** The stainless steel fill box is a major component of a stationary bulk CO<sub>2</sub> fill and vent circuit. It includes the liquid CO<sub>2</sub> fill fitting and vent line termination fitting which safely vents excess CO<sub>2</sub> gas outdoors.

The fill box design has changed to accommodate bulkhead style compression fittings so that the Accuflex vent hose (See chart on page 5 for Vent hose kit part numbers) can be securely connected. The fill box depth dimension has changed to 3 inches deep to accommodate these new bulkhead compression fittings.

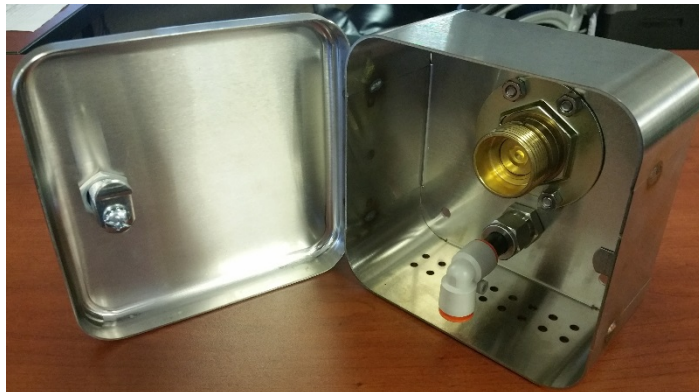

*Surface Mount*

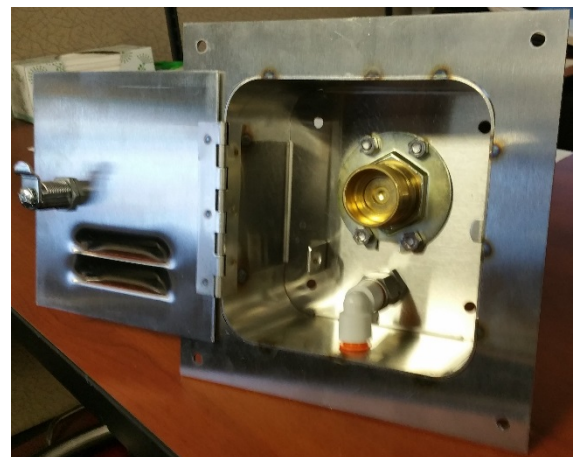

*Flush Mount*

The fill boxes come in two sizes accommodating either a 1/2" bulkhead compression fitting for Carbo-Max<sup>®</sup> 1000 Bulk CO<sub>2</sub> System or a 3/8" bulkhead compression fitting for all other tanks.

Fill Boxes		
20996476	Flush Mount Fill Box with 3/8" Bulkhead	← All other tanks
20996477	Surface Mount Fill Box with 3/8" Bulkhead	
20996475	Flush Mount Fill Box with 1/2" Bulkhead	← Carbo-Max 1000
20996474	Surface Mount Fill Box with 1/2" Bulkhead	

The bulkhead compression fittings incorporate a double Swagelok ODT connector that acts as a fail-safe for the vent tube. With these bulkhead compression fittings the vent tube is passed through the entire bulkhead and extends an inch or two where a push to connect elbow is attached to direct the venting gas to the bottom of the fill box and away from the service tech. Verification of vent tube connection is as easy as opening the fill box and verifying that the vent tube can be seen extending out of the bulkhead compression fitting.

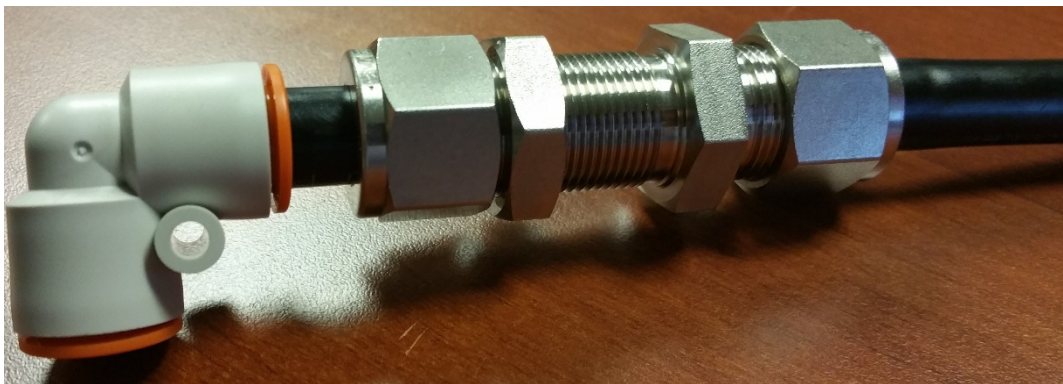

*Bulkhead fitting assembly*

*3/8" Bulkhead (PN 20966036)*

*3/8" Push To Connect Elbow (PN 20966612)*

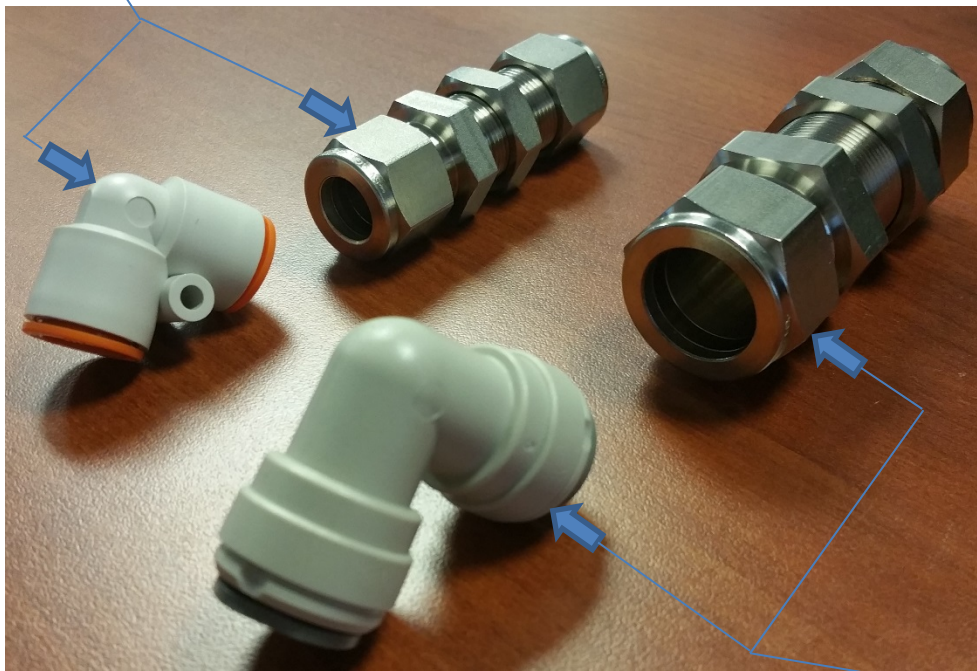

*Bulkheads and Compression Elbow*

*1/2" Bulkhead (PN 20966033)*

*1/2" Push To Connect Elbow (PN 20970110)*

A retrofit bulkhead adapter is available only for the 3/8" Accuflex vent line. If a retrofit fitting is needed for a Carbo-Max® 1000 Bulk CO<sub>2</sub> System a new fill box will need to be ordered to accommodate the new Accuflex vent line. To install the retrofit 3/8" bulkhead adapter you will need to drill a 1-1/16" hole in the fill box.

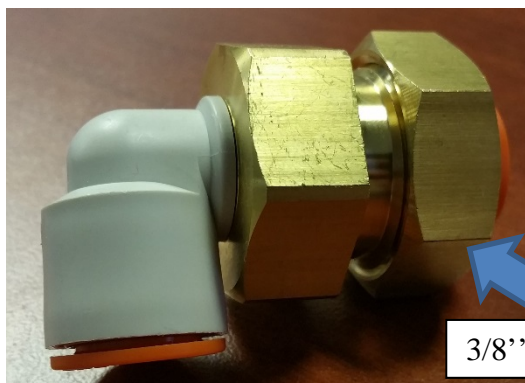

**3/8" Retrofit Bulkhead (PN 20967162)**

*3/8" Retrofit Bulkhead Fitting*



If a conduit is desired for the vent and fill lines you can easily source a 3 inch diameter PVC pipe, 4 inch to 3 inch PVC reducer, and a standard 4 inch PVC flange from plumbing supply stores. The flange mounts directly onto the back of the flush mount fill box.



*Conduit*

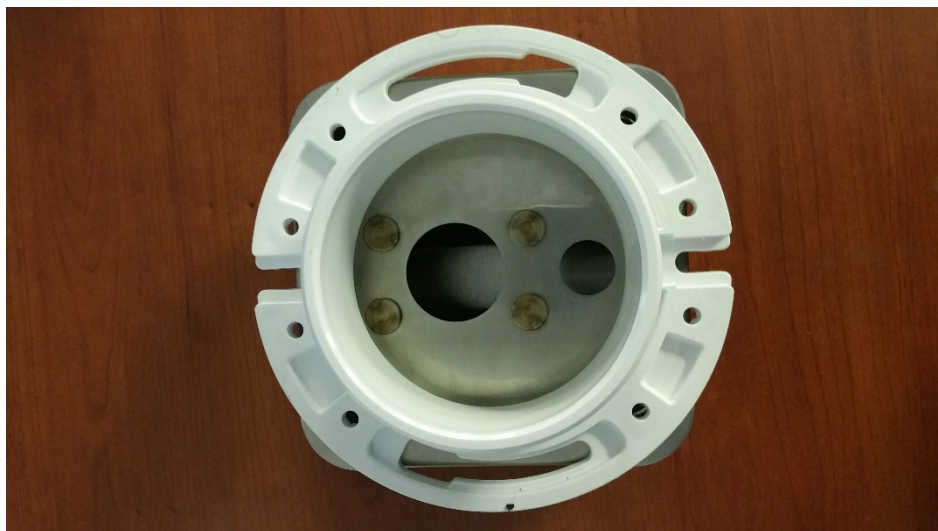

*Flange Mount*

New Hose	
Chart P/N	Description
Accuflex Hoses	
20956973	1/2 Kit Fill/Vent 5'
20956974	1/2 Kit Fill/Vent 10'
20956975	1/2 Kit Fill/Vent 15'
20956976	1/2 Kit Fill/Vent 25'
20956977	1/2 Kit Fill/Vent 30'
20956978	1/2 Kit Fill/Vent 50'
20956754	Fill Hose 5'
20956946	Fill Hose 10'
20956772	Fill Hose 15'
20956945	Fill Hose 25'
20956947	Fill Hose 30'
20956771	Fill Hose 50'
20956979	3/8 Kit Fill/Vent 5'
20956980	3/8 Kit Fill/Vent 10'
20956981	3/8 Kit Fill/Vent 15'
20956982	3/8 Kit Fill/Vent 25'
20956983	3/8 Kit Fill/Vent 30'
20956984	3/8 Kit Fill/Vent 50'

**Contact:** If you have concerns or questions relative to this action, please contact your Chart Technical Service Representative at 1-800-247-4446. Thank you for depending on Chart for high product quality and service.